

SHORE ROAD ALLOWANCE  
(KNOWN AS LAKE DALRYMPLE ROAD)

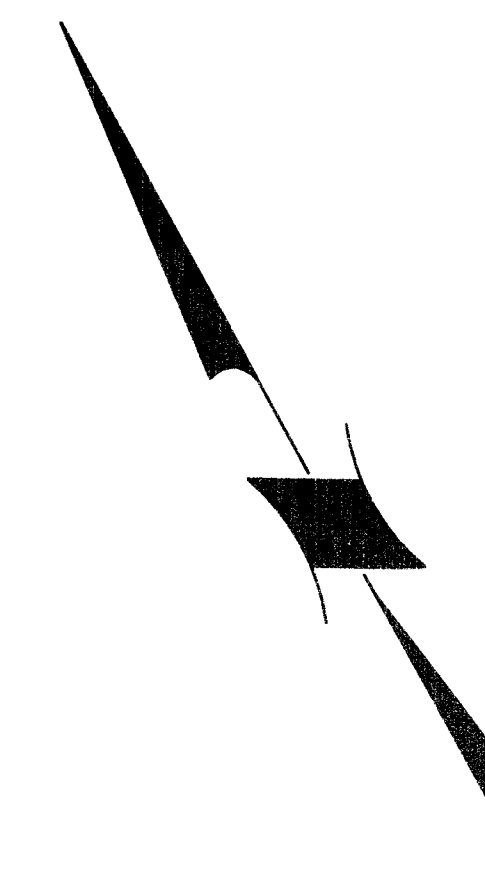

**NOTE:**  
DISTANCES AND ELEVATIONS ARE EXPRESSED IN METRES AND DECIMAL PARTS THEREOF.  
ALL ELEVATIONS ARE GEODETIC REFERRED TO A STEEL ROD WITH BRASS CAP (MTO MONUMENT 818298) ON THE EAST SIDE OF HWY 503, 1.4 KM NORTH OF JUNCTION OF HWY 503 AND DALRYMPLE ROAD, HAVING AN ELEVATION OF 229.622 METRES. GEODETIC (NAD 27). TBM, DOUBLE NAIL IN HYDRO POLE LOCATED ON EAST SIDE OF LAKE DALRYMPLE ROAD AT THE SOUTH EAST CORNER OF SUBJECT LOT, HAVING AN ELEVATION OF 235.989 METRES.  
ALL CONSTRUCTION SHALL BE IN ACCORDANCE WITH CURRENT PROVINCIAL STANDARD DRAWINGS AND SPECIFICATIONS UNLESS OTHERWISE NOTED.  
LOCATIONS AND ELEVATIONS OF ALL EXISTING UTILITIES AND SERVICES SHOWN ON THIS PLAN ARE FOR REFERENCE ONLY. THE CONTRACTOR IS RESPONSIBLE FOR LOCATING AND PROTECTING ALL UTILITIES.  
ALL DIMENSIONS AND ELEVATIONS ARE TO BE CHECKED AND VERIFIED BY THE CONTRACTOR. ANY DISCREPANCIES SHALL BE REPORTED TO THE ENGINEER.  
TOPOGRAPHIC FIELD WORK COMPLETED ON AUGUST 13, 2010.  
BOUNDARY INFORMATION HEREON IS COMPILED FROM A PLAN AND FIELD NOTES OF SURVEY BY DEARDEN AND STANTON LTD., DATED MAY 12, 1983, DEPOSITED AS 57R-3703. BOUNDARY HAS NOT BEEN CONFIRMED BY REGISTRY OFFICE SEARCH AND FIELD WORK.  
SIDELINE GRADES OF ABUTTING PROPERTIES ARE TO REMAIN AS EXISTING.  
MAXIMUM CONTINUOUS LANDSCAPED SIDE SLOPES NOT TO EXCEED 3:1.  
ALL DISTURBED AREAS TO BE SODDED OR SEEDED OVER 75MM OF TOPSOIL.

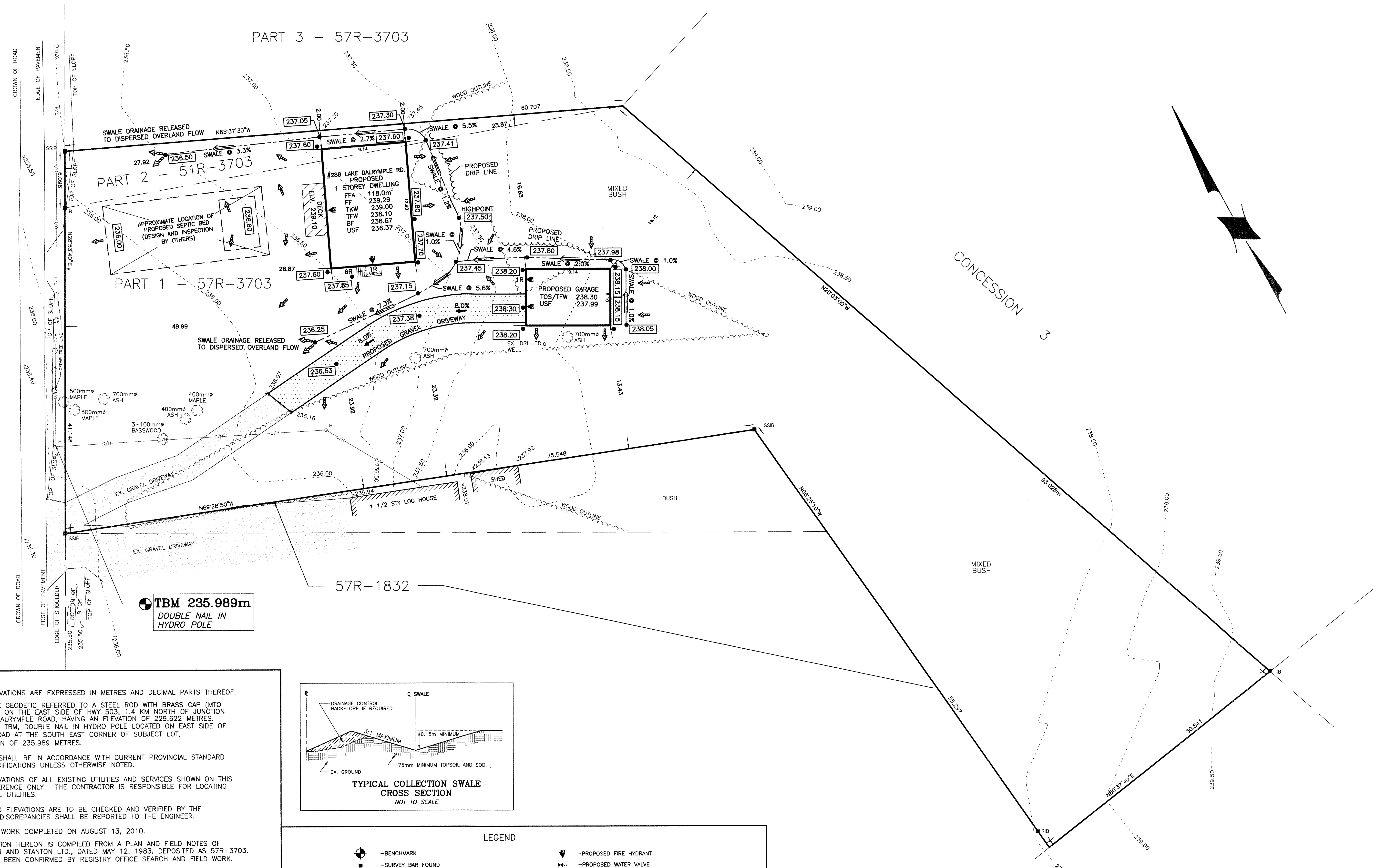
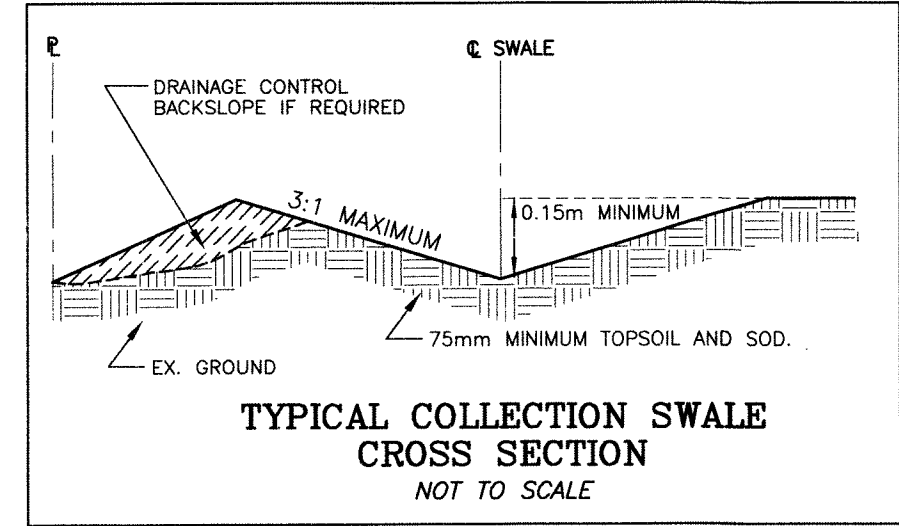

	REQUIRED		PROPOSED	
	DWELLING	GARAGE	HOUSE	GARAGE
LOT AREA	4258.9 m <sup>2</sup> ±			
BUILDING AREA	131.3 m <sup>2</sup> ±			
GARAGE AREA	55.7 m <sup>2</sup> ±			
EXISTING ZONING:	RR2 - RURAL RESIDENTIAL 2			
FRONT YARD SETBACKS:	7.5m Min.	1.2m Min.	27.92m	49.99m
SIDE YARD SETBACKS:	1.2m Min. ON ONE SIDE	1.2m Min.	2.00m	13.43m
	3.0m Min. ON THE OTHER SIDE	1.2m Min.	23.32m	
	(ONE ADDITIONAL METRE FOR EACH ADDITIONAL STOREY ABOVE THE FIRST)			
REAR YARD COVERAGE:	7.5m Min.	1.2m Min.	23.87m	14.12m
	30% Max.	8% Max.	3.0%	1.3%

**LEGEND**

<ul style="list-style-type: none"> <li>● - BENCHMARK</li> <li>■ - SURVEY BAR FOUND</li> <li>□ - SURVEY BAR PLANTED</li> <li>● TSP - TRAVERSE POINT</li> <li>● GV - EXISTING GAS VALVE</li> <li>● CS - EXISTING CURB STOP</li> <li>● WV - EXISTING WATER VALVE</li> <li>● FH - EXISTING FIRE HYDRANT</li> <li>○ AN - EXISTING ANCHOR</li> <li>○ H - EXISTING HYDRO POLE</li> <li>○ H&amp;B - EXISTING HYDRO AND BELL</li> <li>○ LLS - EXISTING LIGHT POST</li> <li>○ W - EXISTING WELL</li> <li>○ BJCT - EXISTING BELL BOX</li> <li>⊠ - EXISTING CABLE TV BOX</li> </ul>	<ul style="list-style-type: none"> <li>◆ - PROPOSED FIRE HYDRANT</li> <li>⋈ - PROPOSED WATER VALVE</li> <li>● L.S. - PROPOSED LIGHT POST</li> <li>■ - CATCHBASIN</li> <li>■ - DITCH INLET CATCHBASIN</li> <li>■ - DOUBLE CATCHBASIN</li> <li>+100.00 - EXISTING GRADE</li> <li>+251.00 - PROPOSED GRADE</li> <li>⊙ - EXISTING STORM MANHOLE</li> <li>⊙ - EXISTING SANITARY MANHOLE</li> <li>⊙ - EXISTING TREE</li> <li>→ - PROPOSED SURFACE DRAINAGE DIRECTION</li> <li>← - PROPOSED SWALE</li> </ul>
---	---

NO.	DD/MM/YY	DESCRIPTION	BY
3	03/07/15	MINOR ADJUSTMENT TO GRADING AND HOUSE ELEVATIONS AS PER CLIENT REQUEST.	J.J.M.
2	09/11/11	PROPOSED BUILDING & GARAGE AND LOT GRADING ADDED	J.J.M.
1	18/08/10	RELEASED FOR COMMENT	J.J.M.

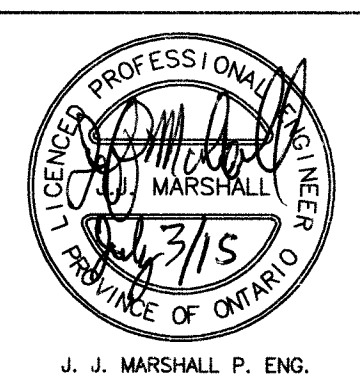

**LOT GRADING PLAN**  
OF No. 288 LAKE DALRYMPLE ROAD  
PARTS 1 & 2, 57R-3703  
TOWNSHIP OF CARDEN  
COUNTY OF VICTORIA  
NOW IN THE  
**CITY OF KAWARTHA LAKES**  
(PREPARED FOR: MR. JIM LAMONT)

**DEARDEN AND STANTON LTD.**  
ONTARIO LAND SURVEYORS  
CANADA LANDS SURVEYORS  
CONSULTING ENGINEERS  
88 COLWATER STREET E. 3RD FLOOR  
PHONE (705)325-9521 FAX (705)325-0241  
www.deardenandstanton.com  
**ORILLIA - ONTARIO**

CAD FILE: KR24936V2  
DRAWN: K.R./S.S.  
CHECKED: J. J. MARSHALL P. ENG.  
DATE: AUGUST 18, 2010  
SCALE: HORZ. 1: 200  
DWG. NO. E-2032  
SHEET 1 of 1